

Professional Powered Speakers

EUROLIVE B205D

Active 150-Watt PA/Monitor Speaker System

- Multi-purpose, 150-Watt, active speaker system for vocal and keyboard monitoring, multimedia, press conferences and home recording studio, etc.
- Revolutionary Class-D amplifier technology: enormous power, incredible sonic performance and super-light weight
- 5.25" premium-quality, full-range neodymium driver with maximum 120 dB SPL @ 1 meter
- Ultra-low noise 3-channel mixer with 3-band EQ
- 2 "Invisible" Mic Preamps with phantom power for condenser microphones and 1 instrument-ready input (no DI required)
- Dedicated stereo input for keyboards, MP3, CD, etc.
- XLR "through" connector with mic/line switch for linking more B205D's
- Mic stand integration system for use with stand and boom
- Integrated limiter for ultimate system control and speaker protection
- Internal switch-mode power supply for noise-free audio, superior transient response and very low power consumption
- Super-tough, impact-resistant enclosure with integrated top carry handle
- High-quality components and exceptionally rugged construction ensure long life
- Conceived and designed by BEHRINGER Germany



What if you could mount your personal monitor on a mic stand and point it right at your face—and what if it sounded really good? What if it sounded so good it could be used as your main PA system for more intimate gigs and meetings? Say hello to the new B205D, an active PA loudspeaker that is small and light enough to mount on a mic stand. But don't let the small size fool you—the B205D cranks out high-fidelity sound and comes loaded with features that will simply astound you!

The Secret to B205D's Amazing Sound

Thanks to our revolutionary Class-D amplifier technology and internal switch-mode power supplies, not only do B205D loudspeakers sound great, they weigh considerably less than most competing active speakers. They pump out 150 of the cleanest, punchiest Watts you've ever heard from a compact loudspeaker, and you can link additional active loudspeaker systems via the handy THRU socket. A built-in mixer provides three input channels, including a switchable instrument-ready input (no DI required), and also features a dedicated 3-band EQ (bass/mid/treble) for simple, yet effective tonal control.

Put the Sound Where You Want It

Space limitations often make it impossible to place full-sized monitor wedges where they can do the most good—and passive monitors require lots of external amplifiers and processing gear to function properly. All this adds up to even more gear to move, and if you don't know what you're doing, you can easily damage passive monitors by applying too much, or even worse, too little power to them. With the B205D we've taken all the guesswork out, giving each loudspeaker its own 150-Watt, Class-D amplifier specifically designed as the perfect mate for the custom-engineered 5.25" neodymium driver.

Say Goodbye to Back-breaking Floor Wedges

By using an internal switch-mode power supply, we reduced the weight of the B205D to a mere 7.0 lbs (3.2 kg). This means that instead of bringing in your old passive floor wedges one-at-a-time, you can carry all your monitors in one trip—without even breaking a sweat! They are small enough to mount on mic stands (each speaker includes a special mic stand integration system), on a tabletop, or they can be placed directly atop a piano or electronic keyboard.

Continued on next page

behringer.com



EUROLIVE B205D

Class-D Technology Delivers High Power, Low Weight

Instead of operating relatively continuously like Class AB circuits, Class-D amps switch on and off thousands of times per second, delivering power only when needed. In other words, the amplifier is either fully on or fully off, which significantly reduces the power losses in the output devices.

When used in conjunction with switching-mode power supplies, our Class-D amplifiers provide tremendous dynamic punch and superior fidelity. The resulting speakers systems are much lighter, making them easy to transport and set up. Our no-compromise design means your B205Ds deliver full power with incredible fidelity all night long, without the need for rest cycles.

Custom-Engineered Drivers

Let's face it; the drivers (otherwise known as speakers) are the only part of a sound system you actually hear. So when it comes to ours, we don't cut any corners. While some of our competitors outsource theirs, we custom-design and build our speakers from scratch. We wind our own voice coils, process the paper pulp into cones and even machine our own speaker back plates and frames. This enables us to control the quality, keep production costs down and frankly, to make better components. The premium-grade 5.25" neodymium driver was designed specifically and optimized solely for use in the B205D.

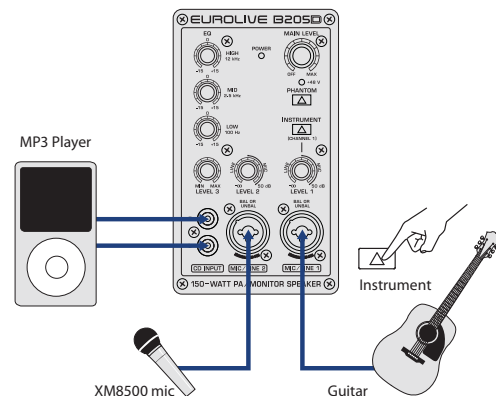

Instant PA System

With just a single B205D loudspeaker system and a microphone, you can set up an instant, high-quality sound system. Thanks to the built-in preamp section, you just connect a dynamic mic and raise and lower the volume with the LEVEL control. Plug in your sound source (CD or MP3 player), place the speaker on a tabletop or mic stand and power up. It's just that easy. And if you need more coverage, you can chain together as many as you like via the convenient LINK OUTPUT XLR connector.

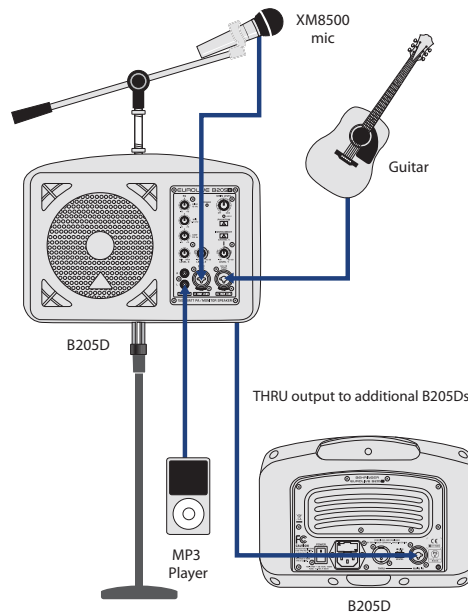

Stereo Music System

You can even use two B205Ds for stereo playback of your MP3, CD or cassette deck without any additional hardware—pretty cool for playing background music or making announcements. Just plug the appropriate stereo "breakout" adapter (not included) into your deck's output jack, run one cable to each loudspeaker and set the Level and EQ controls the same on both B205Ds. Voilà, instant party!

Marvelous Monitoring

When it comes to live monitoring, it just doesn't get any more personal than this. With the B205D, you can literally put the sound where you want it—and the sound quality will simply astound you! It is small and light enough to mount on a mic stand

(it comes with an integration kit that even works with boom stands), yet powerful enough to be used as a small, high-quality PA system. The built-in 3-channel mixer provides tremendous versatility and even allows additional systems to be linked as slaves.

Value

The EUROLIVE B205D provides high-quality sound, tremendous functionality and versatility for very little dough. Best of all, since the B205D is so compact and lightweight, making it easy for you to load in or out at the gig. Compare the B205D to the competition and you'll own BEHRINGER with money to spare!



EUROLIVE B205D

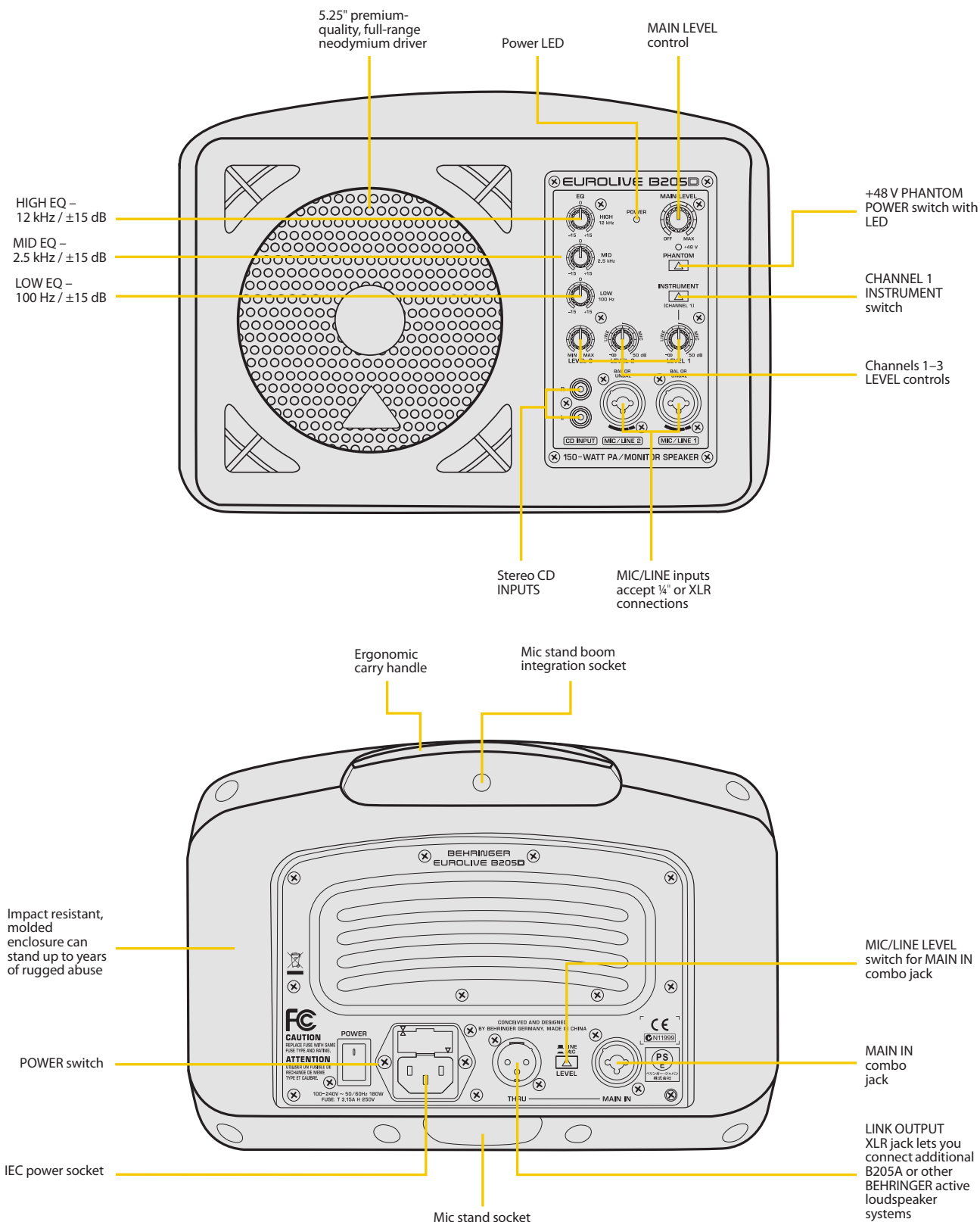

EUROLIVE B205D

SYSTEM DATA

Amplifier Power Output

RMS Power	125 Watts @ 6 Ω
Peak power	150 Watts @ 6 Ω

Speaker

Size	5.25" / 133.5 mm
------	------------------

AUDIO INPUTS

Channel 1: RCA jacks

Sensitivity	-10 dBu to +4 dBu
Input impedance	10 k Ω

Channel 2: XLR / 1/4" TRS combo jacks

Sensitivity	-40 dBu to +4 dBu
Input impedance	20 k Ω

Channel 3: XLR / 1/4" TRS combo jacks

Sensitivity	-40 dBu to +4 dBu
Input impedance	20 k Ω / 1 M Ω switchable

Phantom power

Channels 2 and 3	+48 Volts, switchable
------------------	-----------------------

Channel level controls

Input Trim	$-\infty$ to +30 dB
Max. input level	+22 dBu

Link

Thru XLR connector, mic/line switchable	
Main in	XLR / 1/4" TRS combo jack

LOUDSPEAKER SYSTEM DATA

Frequency response	105 Hz to 10 kHz
Sound pressure level	max. 112 dB SPL @ 1 m
Limiter	Optical
Dynamic equalizer	Processor-controlled

Equalizer

HIGH	> 12 kHz / ± 15 dB
MID	2.5 kHz / ± 15 dB
LOW	< 100 Hz / ± 15 dB

POWER SUPPLY

Voltage (Fuses)

USA / Canada	120 V~, 60 Hz (T 3.15 A H 250 V)
UK / Australia	240 V~, 50 Hz (T 3.15 A H 250 V)
Europe	230 V~, 50 Hz (T 3.15 A H 250 V)
Japan	100 V~, 50/60 Hz (T 3.15 A H 250 V)

DIMENSIONS/WEIGHT

Dimensions (H x W x D)	7.30 x 11.42 x 8.70" 185 x 290 x 220 mm
Weight	7.0 lbs / 3.20 kg

BEHRINGER is constantly striving to maintain the highest professional standards. As a result of these efforts, modifications may be made from time to time to existing products without prior notice. Specifications and appearance may differ from those listed or illustrated.

For service, support or more information contact the BEHRINGER location nearest you:

Europe Tel.: +49 2154 9206 4149, Fax: +49 2154 9206 4199
USA/Canada Tel.: 1 425 672 0816, Fax: +1 425 673 7647
Singapore Tel.: +65 5845 1800, Fax: +65 6214 0275

Australia Tel.: +61 3 9877 7170, Fax: +61 3 9877 7870
Japan Tel.: +81 3 5281 1180, Fax: +81 3 5281 1181



©2010 Red Chip Company Ltd. Technical specifications and appearance subject to change without notice. The information contained herein is correct at the time of printing. All trademarks mentioned belong to their respective owners. BEHRINGER accepts no liability for any loss which may be suffered by any person who relies either wholly or in part upon any description, photograph or statement contained herein. 985-10000-00440

behringer.com